

CRASH CART MANAGEMENT

Prepared By :

Dr. Prabhakaran Arivazhagan

Ms. V. Sathya

Mr. Mahadevan Subramaniyan

Mrs. Vijayalakshmi

Mr. Thirumal Murgan

Ms. Muthumari

Reviewed By :

Dr. Lallu Joseph

Dr. Anuradha Pichumani

Ms. Sudha Srinivasan

Dr. Waseem

Dr. Joseph Fidelis

















Crash cart

- ▶ *Crash cart is a cabinet contains,*
 - ▶ *High risk medications / Emergency medicines*
 - ▶ *Defibrillator & Monitor*
- ▶ *Easily movable/ accessible*
- ▶ *Used during critical situations*
- ▶ *The size, shape and contents of a crash cart may be different between hospital to hospital.*
- ▶ *An adult crash cart is set up differently than a paediatric crash cart.*



Usage of crash cart

- ▶ *To avoid sentinel events*
- ▶ *To start the treatment immediately*
- ▶ *To provide immediate access to supplies and medications*
- ▶ *To facilitate coordination of emergency equipment*
- ▶ *To ensure a properly stocked crash carts will be readily available*
- ▶ *To ensures a properly functioning defibrillator will be readily available*
- ▶ *To save the valuable time at the time of emergency*
- ▶ *It can be mobilized which allows the treatment to come to the patient when needed.*

Objectives of Crash Cart

- ▶ *To identify what is the crash cart consists of*
- ▶ *To identify how to arrange crash cart contents according to policy of the organisation.*
- ▶ *To determine the role of nurse during checking crash cart*
- ▶ *To know the maintenance of crash cart*
- ▶ *To maintain the crash cart stock for one day according to the area*
- ▶ *To ensure crash cart is well maintained and cleaned as per the hospital policy.*

Policies of the crash cart

- *Crash cart must be checked by Assigned Nurse on monthly basis for expiry checking and condition of the equipment. The crash cart is also checked and replaced immediately after its use.*
- *Standardization must be maintained across the hospital.*
 - *Same list of medicines*
 - *Stored in same order.*
 - *Look alike and sound alike medicines should be stored separately as per policy*
- *Defibrillator, equipment maintained by Biomedical Engineer checked by the ward nurse on daily basis.*
- *Crash carts are located in a place which is free of obstacles and can be easily pulled to the location where needed.*

Procedures for checking crash cart

- *After the emergency call, the nurse incharge shall tally the medications/drugs/ items used with the patients case sheet.*
- *The incharge nurse shall raise an indent for the items used after validation by the clinical pharmacist or replace from pharmacy / store.*
- *The assigned pharmacist shall note the indent and coordinate for replacement of the used items.*
- *Check as per the check list.*

Areas of the crash cart

- 1. Emergency department*
- 2. Intensive Care Unit*
- 3. Post Operative ward*
- 4. Operation theatre*
- 5. Paediatric ward*
- 6. Maternity ward*
- 7. All Medical & Surgical ward*
- 8. Outpatient department*
- 9. CT Scan area/ Echo/ Treadmill*
- 10. Dialysis unit*
- 11. Cathlab*
- 12. Other areas should be easily accessible with near by crash cart*

Contents of Crash Cart

UTMB - Pulmonary Care Services Code - 99 Crash Cart Standard

Ver: March 2001

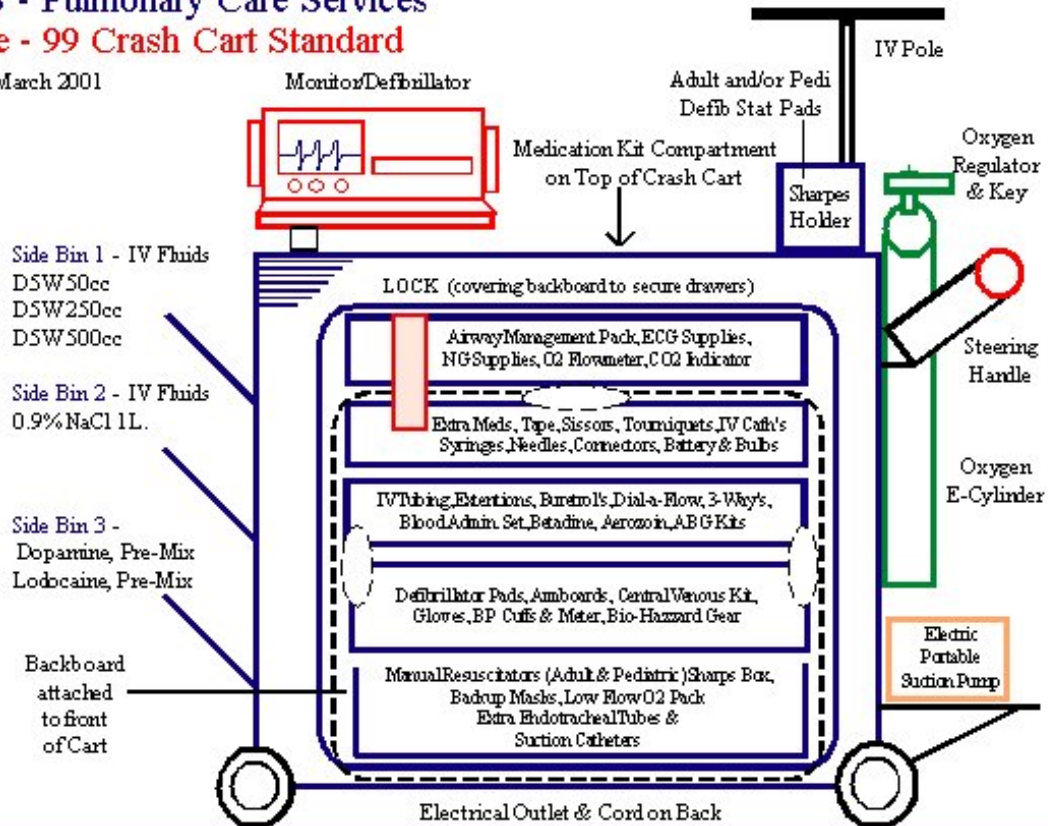

Gene Gill, RRT - Code-99 Cart, March 2001

Code-99 Cart Left Side - I.V. Fluids

Side Bin # 1

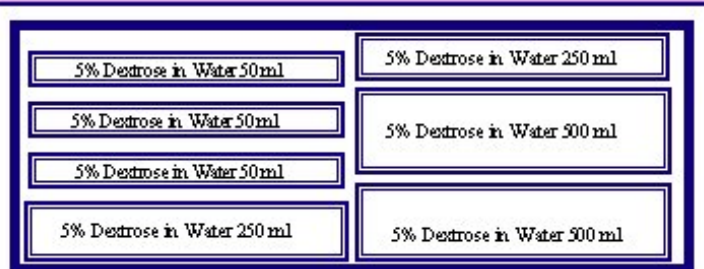

Side Bin # 2

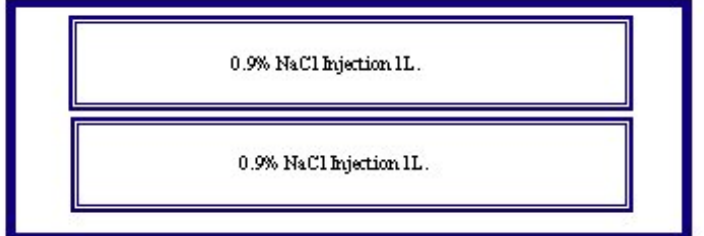

Side Bin # 3

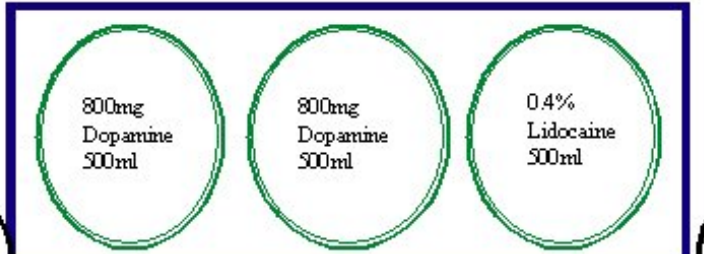

Gene Gill, RRT - Code-99 Cart, March 2001

Code - 99 Emergency Cart Medications Kit & Placements

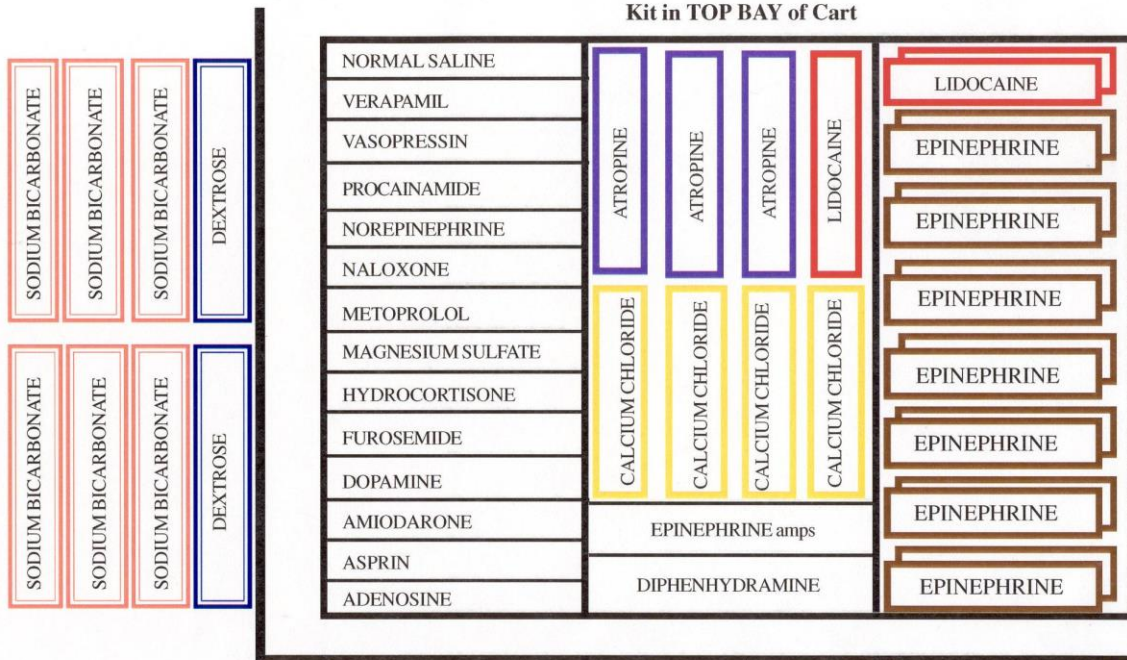

Medications stocked in DRAWER TWO

Medications stocked in SIDE BIN 3



Gene Gill, RRT - Code-99 Cart, December 2001

Emergency Code-99 Cart - Drawer 1

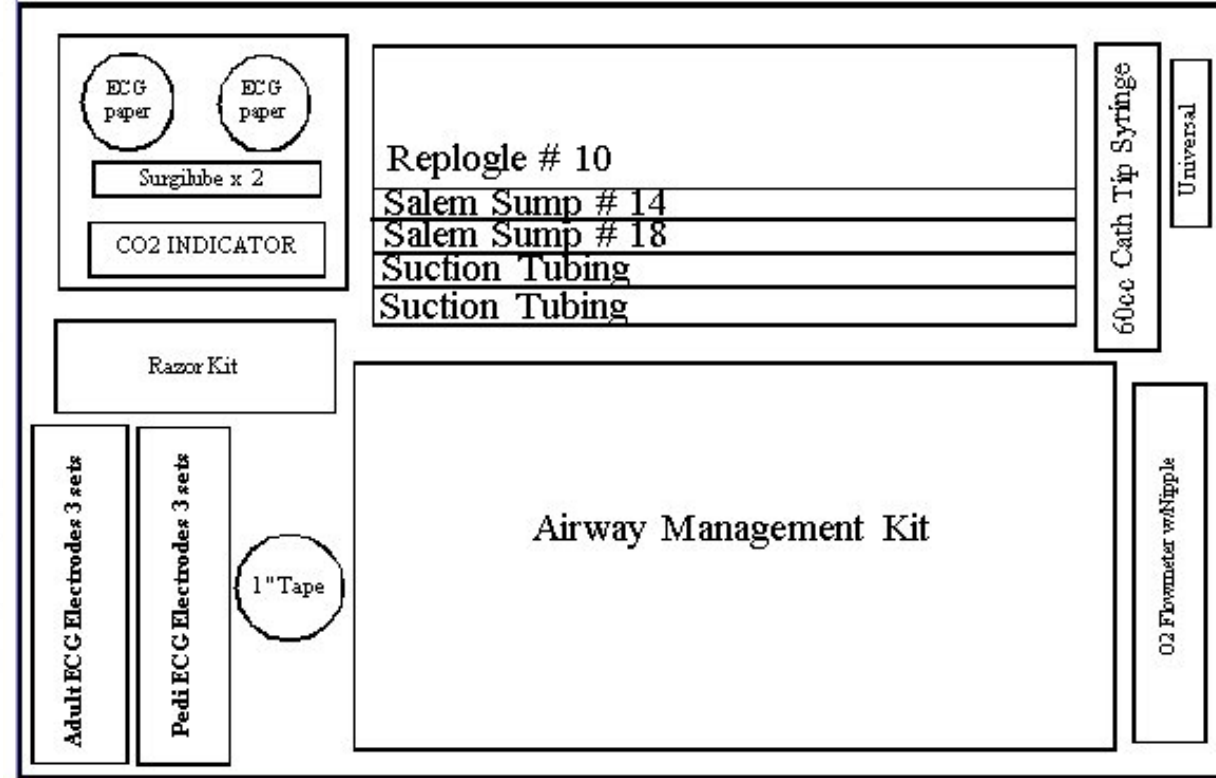

Gene Gill, RRT - Code-99 Cart, March 2001

Code-99 Cart - Drawer #2 Needle & Syringe Tray / Meds

Spacefor Sodium Bicarbonate	Spacefor Dextrose	SYRINGE 60cc	LARYNGOSCOPEBULBS & "C" BATTERY X2	SYRINGE 1cc	SYRINGE 10cc 5 each
Spacefor Sodium Bicarbonate	Spacefor Dextrose	SYRINGE 3.5cc	UNIVERSAL & O2 SUPPLY CONNECTORS	SYRINGE 6 each	
Spacefor Sodium Bicarbonate	Spacefor Dextrose	ANGIO CATH 16G 5.25"	SUTURE 3-0 w/needle & TOURNIQUETS 12"		
Spacefor Sodium Bicarbonate	Spacefor Dextrose	SCISSORS	SPINAL NEEDLES 18G & 22G		
Spacefor Sodium Bicarbonate	Spacefor Dextrose	INSYTE IV CATH 16G	BUTTERFLY NEEDLE 25G		
Spacefor Sodium Bicarbonate	Spacefor Dextrose	INSYTE IV CATH 18G	BUTTERFLY NEEDLE 23G		
Spacefor Sodium Bicarbonate	Spacefor Dextrose	INSYTE IV CATH 20G	LEVER LOCK CANNULA		
Spacefor Sodium Bicarbonate	Spacefor Dextrose	INSYTE IV CATH 22G	VIAL ACCESS CANNULA		
			SYRINGE CANNULA	SYRINGE 3cc	6 each
			Monoject 250 SAFETY NEEDLES 18 X 1 1/2 12 each	SYRINGE 10cc	5 each
			IODINE PREP PADS	TAPE 1" Roll	
			ALCOHOL PREP PADS		

Gene Gill, RRT - Code-99 Cart, March 2001

Code - 99 Cart - Drawer # 3 IV Tubing Supplies

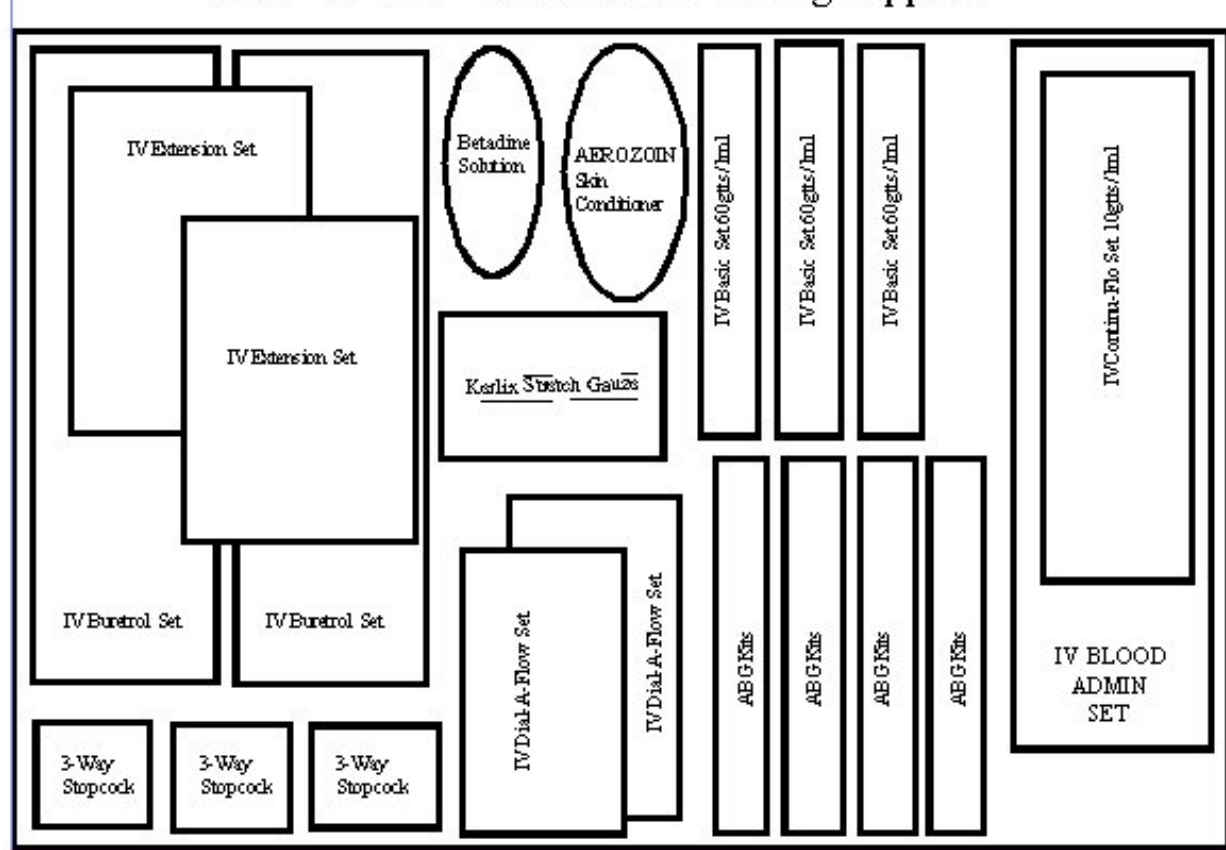

Gene Gill, RRT - Code-99 Cart, March 2001

Code - 99 Cart - Drawer # 4 CV Kit / BP Cuff / Defib Pads / PPE

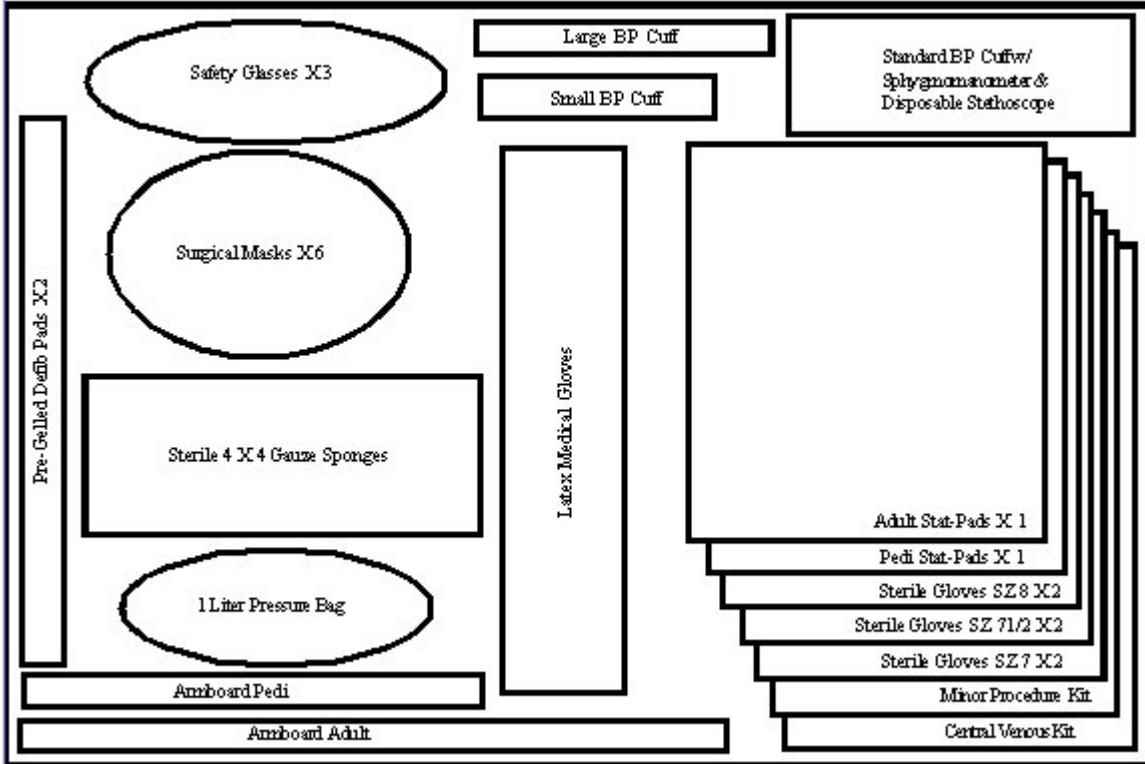

Gene Gill, RRT - Code-99 Cart, March 2001

Code - 99 Cart - Bottom Shelf

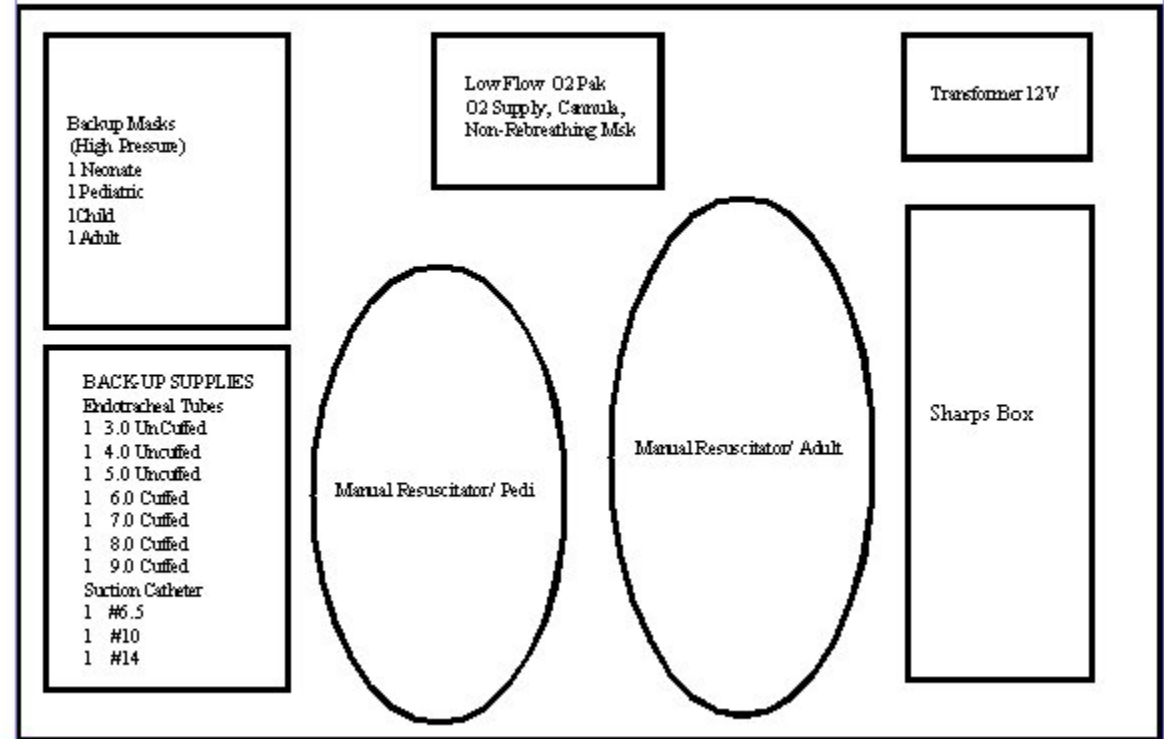

Gene Gill, RRT - Code-99 Cart, March 2001

Crash Cart Top

Defibrillator with leads
Disposable gloves
Sharps container
(1) package of defibrillator pads

Side

O₂ tank
Backboard

Drawer 1 – Medication Drawer

(2) Amiodorone
(1) Atropine 1 mg
(2) Vasopressin
(2) Calcium gluconate
(1) Dextrose 50% 5ml
(2) Isuprel
(4) Epinephrine 1 mg
(3) Lidocaine 100mg
(2) Sodium Bacarbonate 50 meq
(3) Dopamine
(2) Lasix
(2) Dobutamine
(2) Tridil (nitroglycerin)
(2) Pronestyl
(2) Nipride
(2) Verapamil
(1) Magnesium sulfata

Drawer 2 – Airway Management Drawer

Airways, oral, assorted sizes

Airways, nasal trumpet, assorted sizes

Intubation tray – laryngoscopes, non-disposable and disposable with blades

K-Y jelly (2), viscous xylocaine (1)

(2) 10 cc syringes

Stylet

Tape

(1) batteries

ET tubes – sizes 3.0, 6.5, 7.0, 7.5

Yankauer suction

Suction tubing

Suction catheter tray

O₂ mask with tubing

Nasal cannula

(2) ABG kits

Drawer 3 Venipuncture tubes and equipment

(1) 20 ml syringe

(4) 3 ml syringes

(1) TB syringe

IV Start Equipment (4) 18 gauge angiocaths

(4) 20 gauge angiocaths

(1) 22 gauge angiocath

Tourniquet

Assorted butterflies

3 way stopcock

Assorted needles

Band-aids

Betadine swabs

Alcohol swabs

Saline locks

Lidocaine topical solution

Radial artery catheterization set

Tape

Drawer 4

Electrodes
B/P cuff with stethoscope
Assorted sterile gloves
(2) Packages of defibrillator pads
NG tube
(1) 60 ml syringe
Locks

Drawer 5

IV solutions: 1000 ml each of D5W, RL, NS
500 ml each D5W, NS
(2) 100 ml NS
(2) 500 ml Lidocaine 2 grams
(1) Dobutamine

- Dopamine
- Amiodarone IVPB

Tubing (2) microdrips (60 drops/ml)
(2) macrodrips (15 drops/ml)
(2) extension sets

Medication additive labels

LOOK ALIKE MEDICATIONS

S.NO	FORMULATION	BRAND NAME	GENERIC NAME
1	INJECTION	BIOVORIN	LECOVORIN CALCIUM
	INJECTION	BIOTREXATE	METHOTREXATE
2	INJECTION	TERLJEON	TERLIPRESSIN
	INJECTION	MILRINEON	MILRINONE
3	INJECTION	OMIKACIN	AMIKACIN
	INJECTION	DEXALAB	DEXAMETHASONE
4	INJECTION	KNEON	MENADIONE
	INJECTION	KETOROL	KETOROLAC
5	INJECTION	FEVASTIN	PARACETAMOL
	INJECTION	FRUSEMIDE	FUROSEMIDE
6	INJECTION	DEXTOMID(1ML)	DEXMEDETOMIDINE
	INJECTION	DEXTOMID(2ML)	DEXMEDETOMIDINE
7	INJECTION	ADVENT(300MG)	AMOXYCILLIN+CLAVULANIC ACID
	INJECTION	ADVENT(600MG)	AMOXYCILLIN+CLAVULANIC ACID
8	INJECTION	HEPARIN(5000U)	HEPARIN
	INJECTION	BEPARIN(25000)U	HEPARIN
9	INJECTION	ACTILYSE(20MG)	ALTEPLASE
	INJECTION	ACTILYSE(50MG)	ALTEPLASE
10	INJECTION	VASOCON	ADRENALINE
	INJECTION	EPHRES	EPHEDRINE
11	INJECTION	PYROLATE	GLYCOPYROLATE
	INJECTION	TROPINE	ATROPINE
12	TABLET	AMLONG 10MG	AMLODIPINE
	TABLET	ANXIT 0.25MG	ALPRAZOLAM
13	TABLET	ATIVAN 1MG	LORAZEPAM
	TABLET	WYSOLONE 5MG	PREDNISOLONE
14	TABLET	AVIL 25MG	PHENIRAMINE MALEATE
	TABLET	LASIX 40MG	FRUSEMIDE
15	TABLET	LIVOGEN	MULTIVITAMIN
	TABLET	LIVOGEN- Z	MULTIVITAMIN+ZINC
16	TABLET	DOMSTAL 10 MG	DOMPERIDONE
	TABLET	ALPRAX 0.25 MG	ALPRAZOLAM
17	CAPSULE	MAXGALIN 75MG	PREGABALIN
	CAPSULE	GABANTIN 300MG	GABAPENTIN
18	CAPSULE	NODOSIS	SODIUM BICARBONATE
	CAPSULE	MYOSPAZ	CHLORZOXAZONE & PARACETAMOL
19	CAPSULE	BIFILAC	LACTICACID BACILLUS
	CAPSULE	BIFILAC HP	L.A.B + S.FAECALIS
20	CAPSULES	SOMPRAZ - D	ESOMEPRAZOLE+DOMPERIDONE
	CAPSULES	SOMPRAZ - IT	ESOMEPRAZOLE+ITOPRIDE
21	CAPSULE	BECOSULES	VITAMIN B COMPLEX
	CAPSULE	BECOSULES -Z	VITAMIN B COMPLEX + ZINC

PTC CHAIRPERSON

MEDICAL SUPERINTENDENT

VP OPERATIONS

SOUND ALIKE MEDICATIONS

S.NO	FORMULATION	BRAND NAME	GENERIC NAME
1	INJECTION	DROTIN	DROTAVERINE
	INJECTION	TROPINE	ATROPINE
2	INJECTION	TROPINE	ATROPINE
	INJECTION	STROPIN	CEREBROPROTEIN HYDROSYLATE
3	INJECTION	SOLUMEDROL	METHYLPREDNISOLONE
	INJECTION	DEPOMEDROL	METHYLPREDNISOLONE ACETATE
4	INJECTION	GRAFEEL	FILGRASTIM
	INJECTION	GRAFALON	ANTITHYMOCYTE IMMUNOGLOBULINS
5	INJECTION	ESOMAC	ESOMEPRAZOLE
	INJECTION	ESOCARD	ESMOLOL
6	INJECTION	IMIRIA	IMIPENEM+CILASTATIN
	INJECTION	MERIVA	MEROPENAM
7	INJECTION	DEXTOMID	DEXMEDETOMIDINE
	INJECTION	DEXIM	DEXAMETHASONE
8	INJECTION	KLOTIN	TRANEXAMIC ACID
	INJECTION	KLOTIM	CO-TRIMOXAZOLE
9	INJECTION	NOSTAF	CEFAZOLIN
	INJECTION	STAPHONEX	FLUCLOXACILLIN
10	INJECTION	MIFIC PLUS	MINOCYCLINE
	INJECTION	TIGEFIC PLUS	TIGECYCLINE
11	INJECTION	AMBISOME	AMPHOTERICIN - B LIPOSOMAL
	INJECTION	AMPHOTIN	AMPHOTERICIN - B LYOPHILIZED
12	POWDER	MOVICOL	FPOLYETHYLENE GLYCOL & ELECTROLYTES
	POWDER	MONUROL	FOSFOMYCIN TROMETAMOL
13	INJECTION	GRAFALON	ATG RABBIT
	INJECTION	GRAFEEL	FILGRASTIM
14	INJECTION	TIGEFIC PLUS	TIGECYCLINE
	INJECTION	TICOFIC PLUS	TEICOPLANIN
15	INJECTION	FORZID	CEFTAZIDIME
	INJECTION	FORCAN	FLUCONAZOLE
16	INJECTION, TAB	CIPLOX	CIPROFLOXACIN
	TABLET	CIPLAR	PROPRANOLOL
17	INJECTION	TAXIM	CEFOTAXIM
	TABLET	TAXIM-O	CEFIXIM
18	INJECTION, TAB.	DROTIN	DROTAVERINE
	TABLET	TROPINE	ATROPINE
19	INJECTION	NITROCIN	NITROGLYCERIN
	TABLET	NITROSUN	NITRAZEPAM
20	CAPSULE	CILAMIN	D-PENICILLAMINE
	TABLET	CLARIMIN	CLARITHROMYCIN

21	TABLET TABLET	CIPLAR CILICAR	PROPRANOLOL CILNIDIPINE
22	TABLET TABLET	CARDACE CARDIVAS	RAMIPRIL CARVEDILOL
23	TABLET TABLET	INDERAL INSPIRAL	PROPRANOLOL METHYLPHENIDATE
24	TABLET TABLET	LAMITOR LAMIVIR	LAMOTRIGINE LAMIVUDINE
25	TABLET	MAGVITE	MAGNESIUM + VITAMIN B6 + PHOSPHORUS + NICOTINAMIDE
	TABLET	MAGVION	MAGNESIUM HYDROXIDE
26	TABLET	ZENETEL	ALBENDAZOLE
	TABLET	TRENTAL	PENTOXYPHYLLINE
27	TABLET	VOLIBO	VOGLIBOSE
	TABLET	VIBOLIV	METADOXINE
28	TABLET	VALCIVIR	VALACYCLOVIR
	TABLET	VALCYTE	VALGANCICLOVIR
29	TABLET	SHELCAL	CALCIUM CARBONATE AND VIT D3
	TABLET	SHELCAL OS	ALFACALCIDOL & CALCIUM CARBONATE
30	CAPSULE	RCIN	RIFAMPICIN
	TABLET	RCINEX	RIFAMPICIN+ISONIAZID
31	CAPSULE	MYELOSTAT	HYDROXYLUREA
	TABLET	MELOSET	MELATONIN
32	SYRUP	ASCORIL	BROMOHEXINE+GUAIFENESIN+MENTHOL+TER BUTALINE
	SYRUP	ASCORIL-LS	AMBROXYL+LEVOSALBUTAMOL+GUAIFENESIN
33	SYRUP	CREMAFFIN	LIQUID PARAFFIN+MAGNESIUM HYDROXIDE
	SYRUP	CREMAFFIN PLUS	LIQUID PARAFFIN+MAGNESIUM HYDROXIDE+SODIUM PICOSULPHATE
34	SYRUP	SUCRAFIL	SUCRALFATE
	SYRUP	SUCRAFIL-O	SUCRALFATE+OXETACAINE
35	SYRUP	TUSQ-X	BROMOHEXINE+GUAIFENESIN+TERBUTALINE
	SYRUP	TUSQ-DX	CHLORPHENERAMINE MALEATE+PHENYLEPHRINE+DEXTROMETHOR PHAN

PTC Chairperson

MEDICAL SUPERINTENDENT

VP OPERATIONS

